

**FICHE D'HOMOLOGATION  
HOMOLOGATION FORM**



**COMMISSION INTERNATIONALE  
DE KARTING – FIA**



**PROTECTION ARRIERE / REAR PROTECTION**

Constructeur	<i>Manufacturer</i>	Righetti Ridolfi Spa
Marque	<i>Make</i>	Righetti Ridolfi
Modèle	<i>Model</i>	XTR14
Catégorie	<i>Category</i>	Toutes / All
Durée de l'homologation	<i>Validity of the homologation</i>	6 ans / years
Nombre de pages	<i>Number of pages</i>	4



La présente Fiche d'Homologation reproduit descriptions, illustrations et dimensions au moment de l'homologation CIK-FIA.



*This Homologation Form reproduces descriptions, illustrations and dimensions at the moment of the CIK-FIA homologation.*

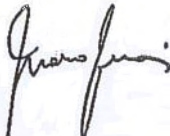

PHOTOS VUE DE DERRIERE, DE DESSUS ET DE COTÉ, DE LA PROTECTION ARRIERE AVEC SES SUPPORTS

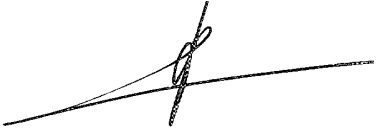
*PHOTO FROM REAR, ABOVE AND SIDE OF REAR PROTECTION WITH ITS SUPPORTS*

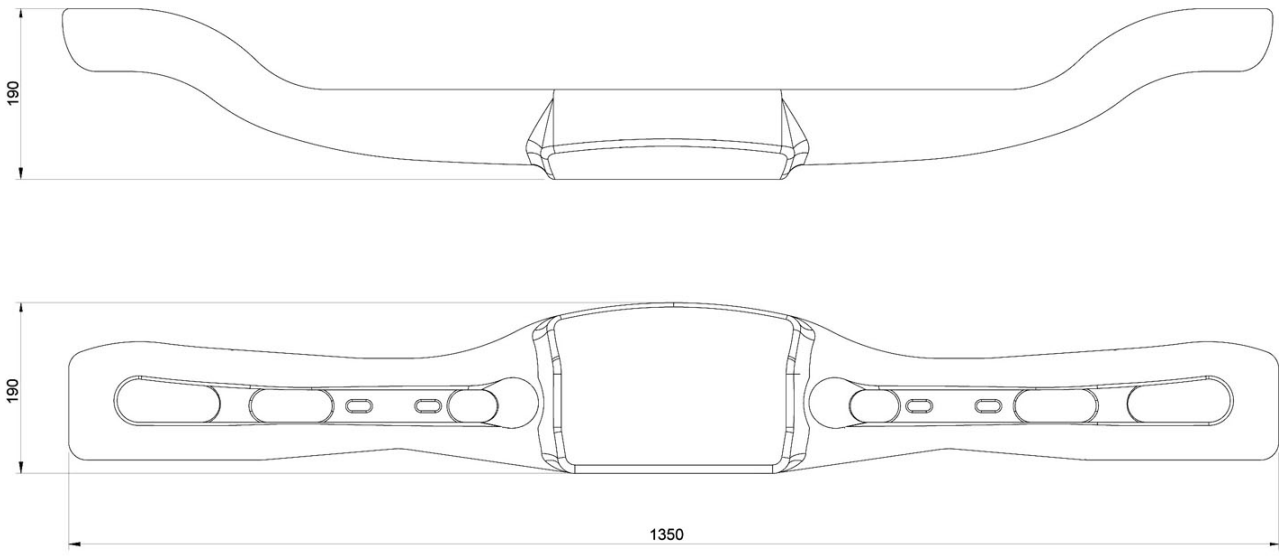
Signature et tampon de l'ASN <i>Signature and stamp of the ASN</i>	Signature et tampon de la CIK-FIA <i>Signature and stamp of the CIK-FIA</i>
 	 

<b>PROTECTION ARRIERE - CARROSSERIE</b> Dessin technique (dimensions d'encombrement)		<b>REAR PROTECTION - BODYWORK</b> Technical drawing ( main external dimensions)	
Poids en g (carrosserie seule)	Weight in g (bodywork only)	<b>1600 g</b>	+/-10 %
			
PHOTO (carrosserie seule) / (bodywork only)			
			

**SUPPORTS DE FIXATION**  
Dessin technique éclaté**ATTACHMENT SUPPORTS**  
*Exploded technical drawing*

Poids en g

Weight in g

**950 g**

+/-5 %

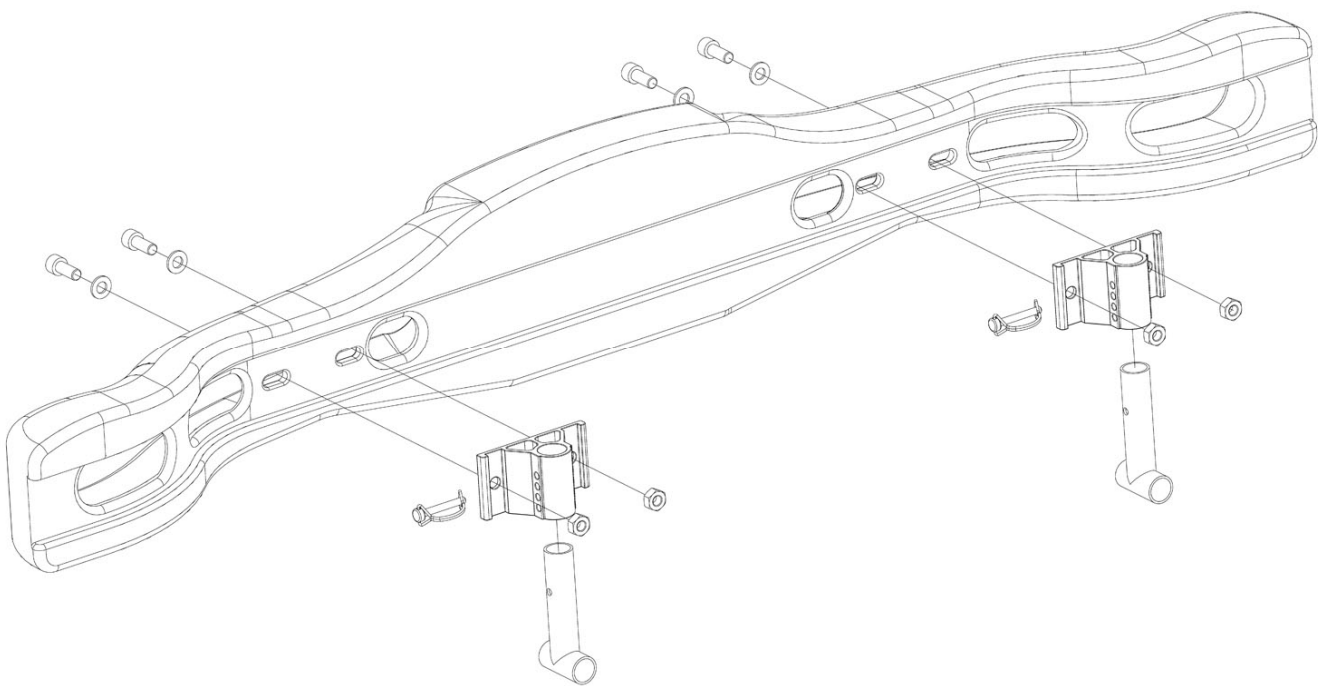

PHOTO DU MARQUAGE DU NUMERO  
D'HOMOLOGATION (et du logo CIK-FIA sur les  
éléments plastiques)

PHOTO OF THE HOMOLOGATION NUMBER  
MARKING (and of the CIK-FIA logo on the  
plastic parts)

**Le marquage doit rester clairement visible en permanence**  
**The marking must be clearly visible at all times**

CARROSSERIE

BODYWORK



SUPPORTS

